

## How to install Seals in ML55 pump

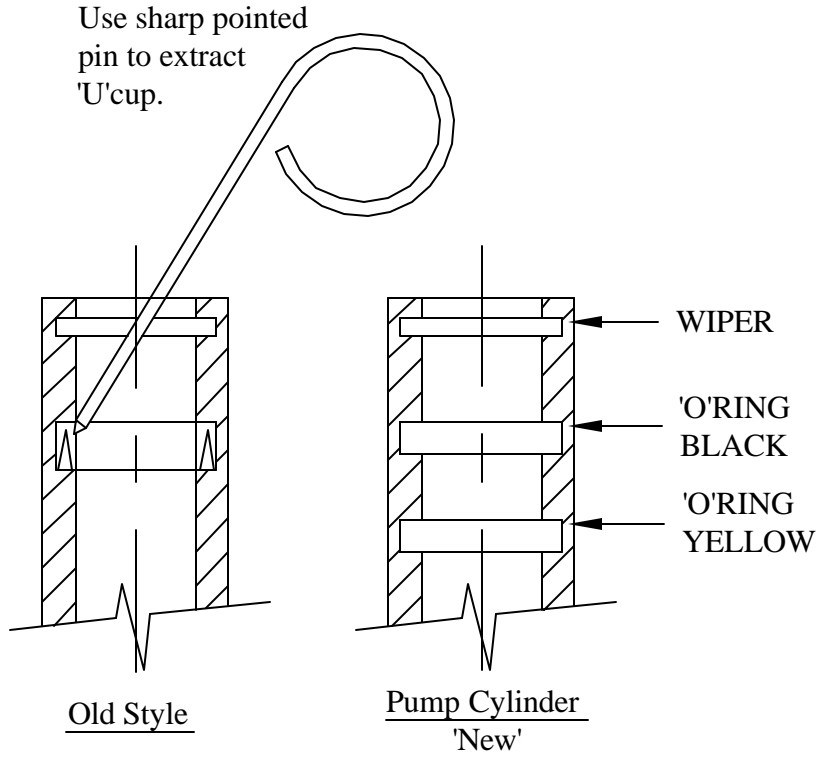

### How to deform 'U' Cup for installation in cylinder groove

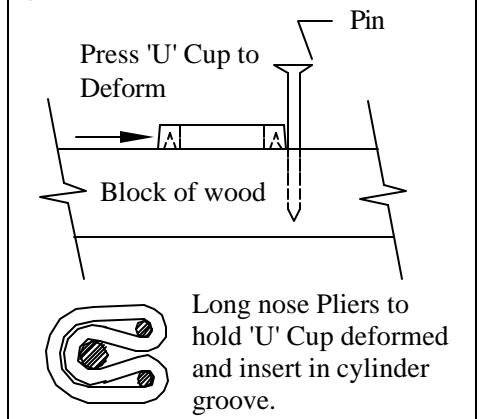

To check or replace seals on lift rod. Place Block of wood under the frame.

Release Lock Ring from head of truck. Lift jack by handle sepressing the Lift Rod to the floor.

Jack should swing away from head giving access to Lock Rings on top of the Lift Cylinder. Remove same and extract Lift Rod Assy. For seal inspection, reverse procedure for assy.

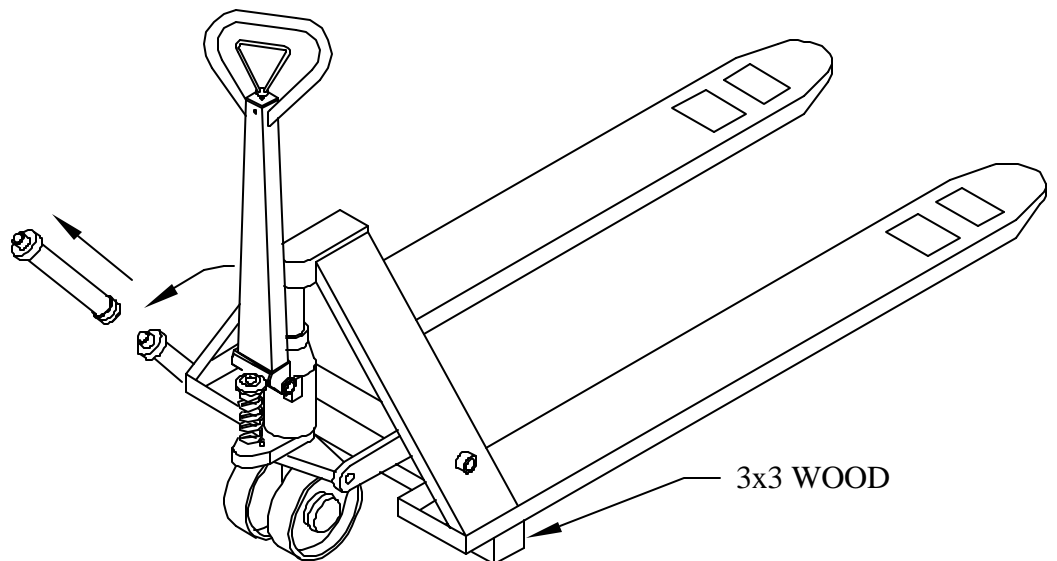

With jack attached to truck frame, remove handle by extracting hinges, pins and chain connection. Remove pump piston with spring. Clean all residue from outer surface. Replace seals in cylinder, examine pump piston for nicks and gouging before assembly.